





















When the front lid is closed, the unit will restore to its previous setting.

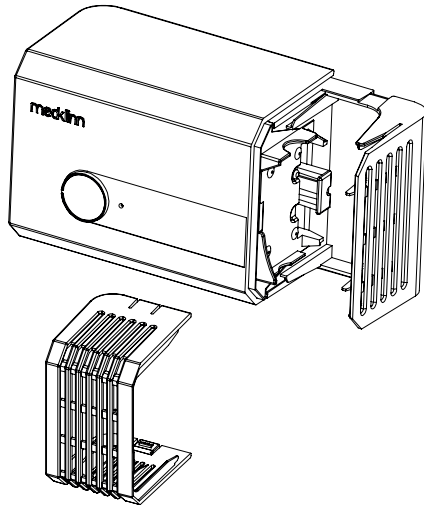

### CAUTION

A safety feature is incorporated to prevent electrical shock.

In the event the front lid is detached while the unit is still operating, the LED light will become unlit. This indicates the power to the Cerafusion™ Cartridge has been cut off.

### CLEANING OF DEVICE

#### **!** CAUTION: SWITCH OFF AND UNPLUG THE UNIT BEFORE CLEANING

Due to water evaporation and accumulation of fine dust or other pollutants, there may be some stains around the ventilation holes.

#### CLEANING THE EXTERNAL PART OF DEVICE:

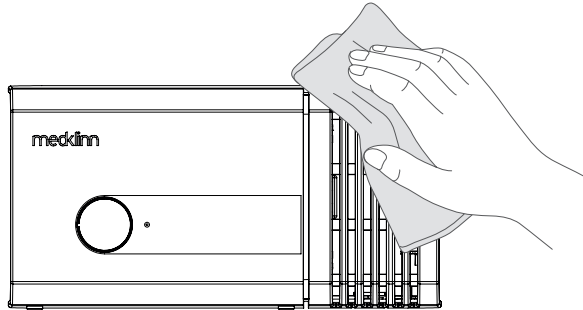

Wipe the device gently with a slightly damp cloth.

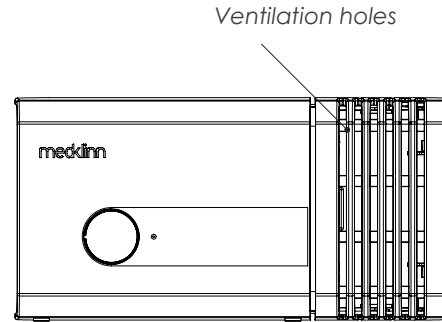

Ensure ventilation holes are not clogged with dust or dirt.

CLEANING THE INTERNAL PART OF DEVICE:

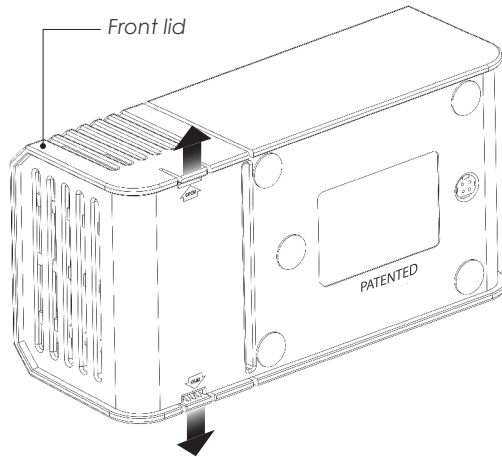

**Step 1:** Push the latch outward slightly to open the front lid.

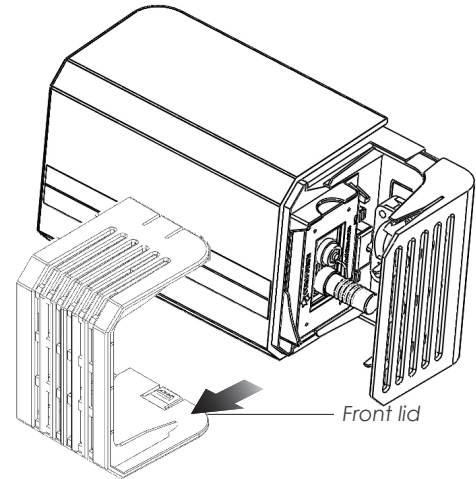

**Step 2:** Pull out the front lid.

**!** CAUTION:

THE CERAFUSION™ CARTRIDGE COULD BE HOT. BE CAREFUL WHEN REMOVING IT.

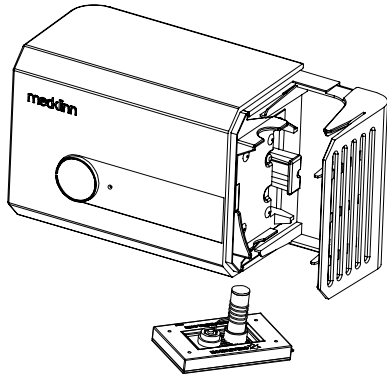

**Step 3:** Remove the Cerafusion™ Cartridge.

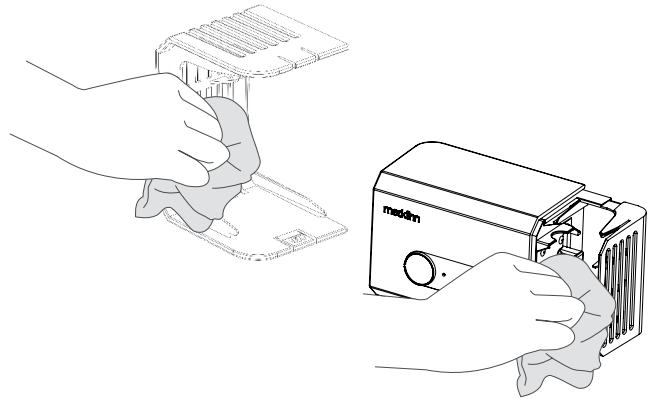

**Step 4:** Clean the front lid and internal surfaces with a slightly damp cloth.

### REPLACING CERAFUSION™ CARTRIDGE *(recommended every 12 months)*

#### **!** CAUTION:

1. ENSURE THAT THE UNIT IS SWITCHED OFF BEFORE REPLACING CARTRIDGE TO AVOID ELECTRICAL SHOCK.
2. DO NOT HOLD THE GLASS TUBE WHEN HANDLING THE CARTRIDGE.
3. DO NOT TURN OR TWIST THE GLASS TUBE AS IT WILL DAMAGE OR CRACK THE GLASS.

#### IMPORTANT NOTE:

If the living space is more dusty or dirty, you may need to change the cartridge more often.

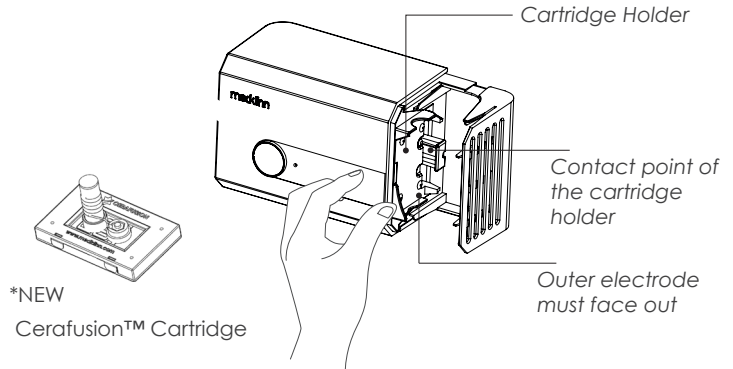

1. **I have switched on the unit, but the LED light is not lit and there is no hissing sound.**

First, check that the power supply jack is properly inserted to the unit and that the adaptor is connected to the power outlet and switched on. Second, make sure the front lid is properly closed. If the LED light is still unlit, contact Medklinn Service Centre to have the unit serviced.

2. **I have dropped the unit. Is it safe to continue using it?**

First, carefully check the whole unit to make sure there are no cracks or breaks externally and internally. Next, check the glass tube of the cartridge to make sure it is not cracked or broken. If there is any component damage, contact Medklinn Service Centre.

3. **There is a “hissing” sound coming from the unit. Is this normal?**

Yes. It is normal. The “hissing” sound indicates that the Cerafusion™ Cartridge is generating active oxygen.

4. **I have switched on the unit, the LED lights are lit, but there is no “hissing” sound coming from the unit.**

First, check if the Cerafusion™ Cartridge is properly inserted into the cartridge holder. If there is still no “hissing” sound after cleaning, replace a new cartridge or contact Medklinn Service Centre to have the unit serviced.

## SPECIFICATIONS

MODEL	ASENS+ 20	ASENS+ 40
Input Voltage to adapter	110 ~ 240v AC, 50/60 Hz	
Output Current (max) from adapter	1.5 Amp @ 12 VDC	
Power Consumption	< 5.5 watts	
Functions	Low / Mid / High	
Dimensions (mm)	195(W) x 101(H) x 76(D)	
Operating Environment	Temperature 5° - 35°C	
Coverage Area*	Up to 200 square feet	Up to 400 square feet
Weight (unit + power supply)	750 grams	
Warranty	1 year limited	

\* 1) Depending on the pollution level. 2) Ceiling height of 9 feet. 3) Refer to the recommended setting for different coverage area.